

# Color Planning for toilet considering low-visioned people

弱視者を考慮したカラープランニング



## Color planning of the restroom and Basic study of universal color design

collaborated with  
Takashi Shimizu (West Japan Railway company)  
JR West Japan Consultants Company



Basic study of color planning for restroom in public building.

Color planning of the restroom in the printing company building.

弱視者を考慮した公共建築のトイレの色彩計画についての基礎的研究

印刷会社のトイレのための色彩計画

## 1st Step

When I lost my contact lens, it was so hard to use restroom by myself. So, I had a question, "Are restrooms in train stations usable for everyone? Especially for people who have poor-vision." Many restrooms in train station have white wall because the bright color gives people cleaner image. However, its contrast between wall and urinals is low, so low-visioned people can't find urinals easily.

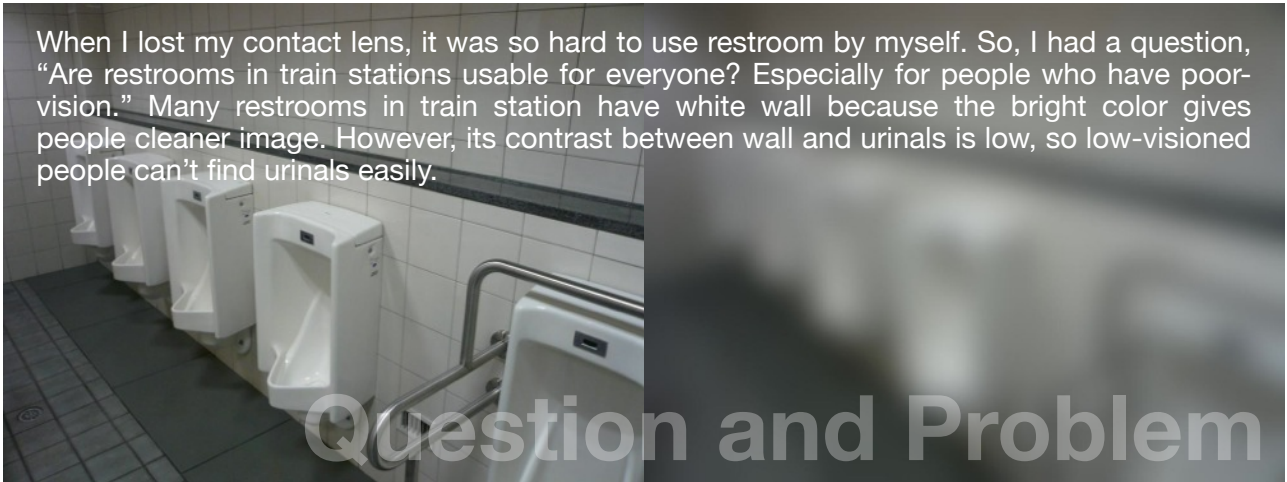

## 2nd Step

Simulation

We researched many restrooms, and then, we simulated various color combinations in order to examine the better pattern of interior colors, which gives us good effects of contrast with minimum operation.

Furthermore, we believed that this was the universal design.

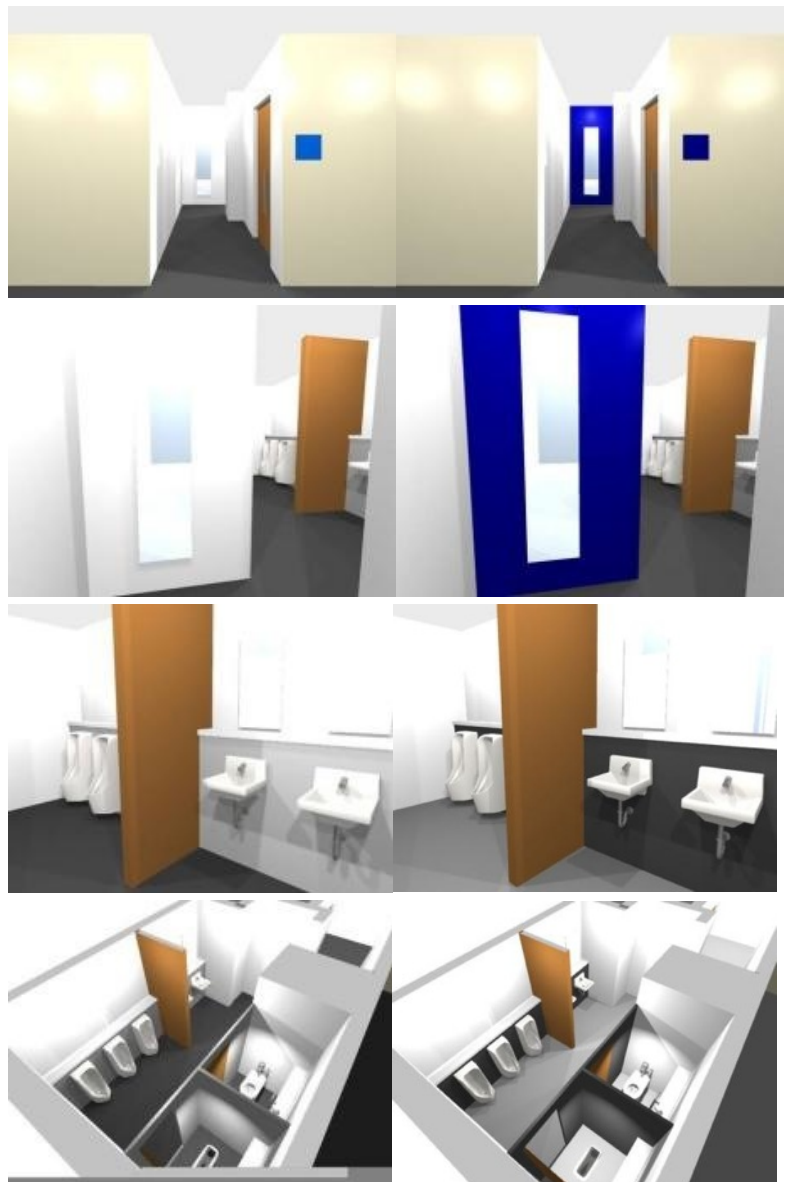

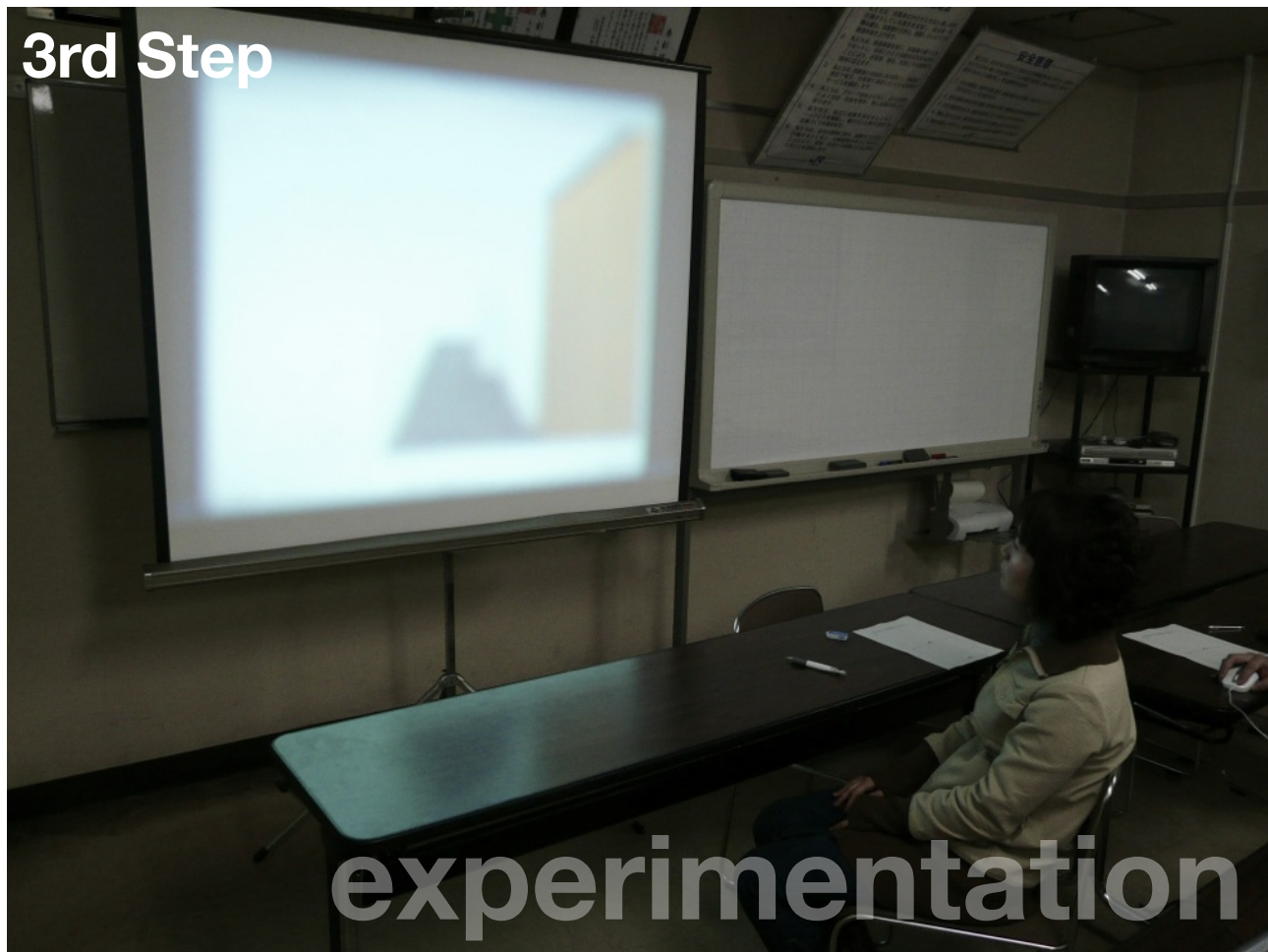

Finally, we had experimentations to examine which combination was better to recognize a shape of the space with the “sketch map” method.

To reproduce the situation of low-vision, we shaded off screen reflected by a projector.

Q. 映像を見て把握できたトイレの平面図と器具のレイアウトを描いてください。

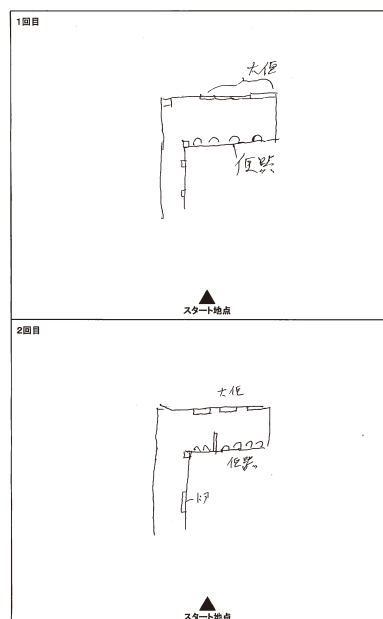

Q. 映像を見て把握できたトイレの平面図と器具のレイアウトを描いてください。

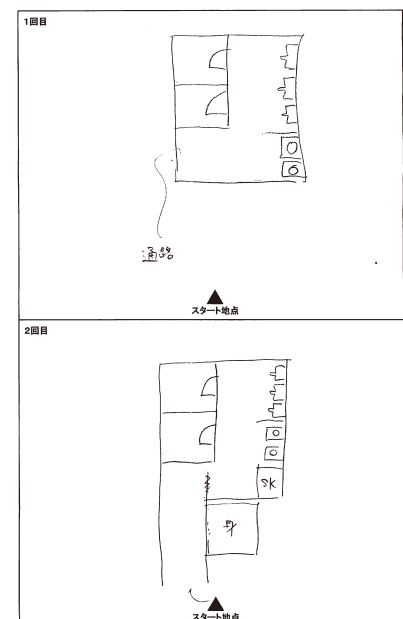

Summaries of technical papers of Annual Meeting Architectural Institute of Japan  
**Study of color planning for rest room that people with low-vision were considered [in Japanese,2008]**



## Planning

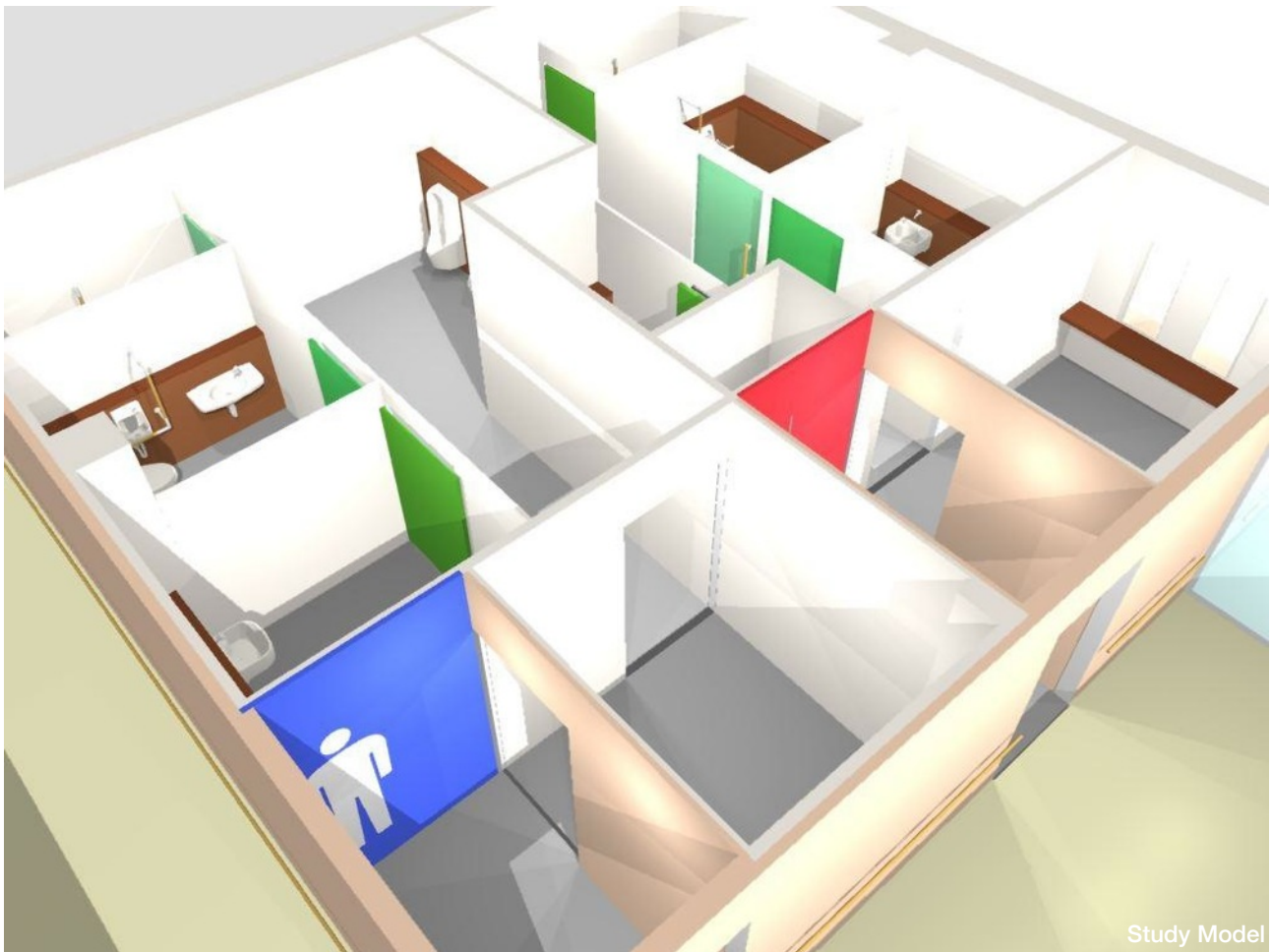

## Photo



the exterior of the building



the exterior of the building





the entrance of the men's restroom



the interior of the men's restroom



the interior of the restroom



Each door has different colors in order to feel the slight differences in color. Because this restroom is designed for Printing company and employees must be sensitive for colors

the interior of the restroom

Summaries of technical papers of Annual Meeting Architectural Institute of Japan  
**Study of color planning for rest room that people with low-vision were considered [in Japanese,2008]**